

## How To Use the Cable Tensioning Tool

The Tensioning Tool with the 90-degree Adapter requires a minimum gap of 2-1/2" between the Quick-Connect® post and a wall or other fixed surface.

Cables need to protrude a minimum of 10-inches out of the Quick-Connect® Inset fitting in order for the tool to properly grip the cable.

Insert the tip of the Guide Plate into the into the Quick-Connect® Inset fitting.

Spread the handles to open up the gripping jaw.

Pass the cable through the grooved area of the tool and into the spring loaded gripping jaw.

(See Figure 4)

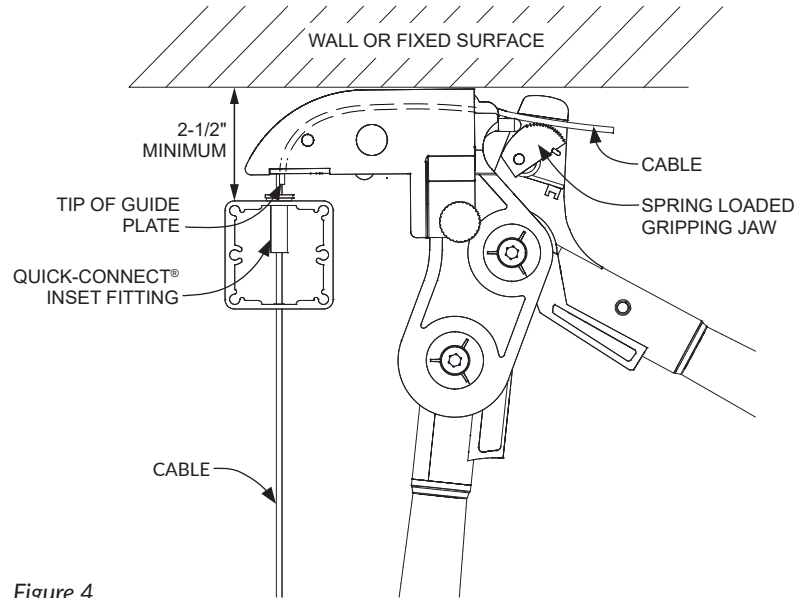

Figure 4

With the cable in the gripping jaw, close the handles smoothly to tension the cable. An audible "click" and a slight kickback at the handles indicates that the selected tension has been achieved.

If you have extra cable slack you may need to repeat the process a second time.

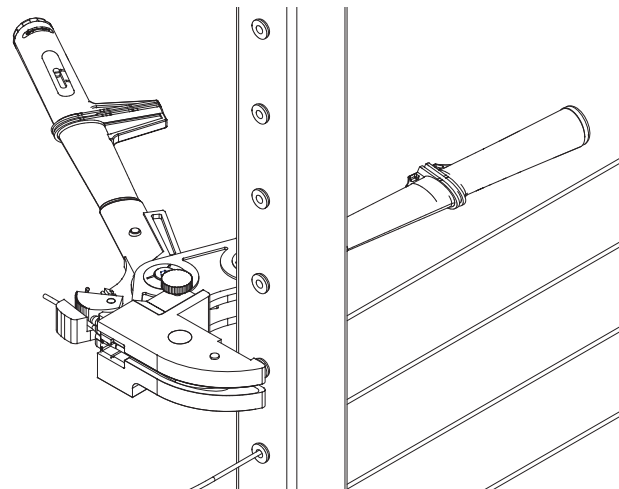

Figure 5

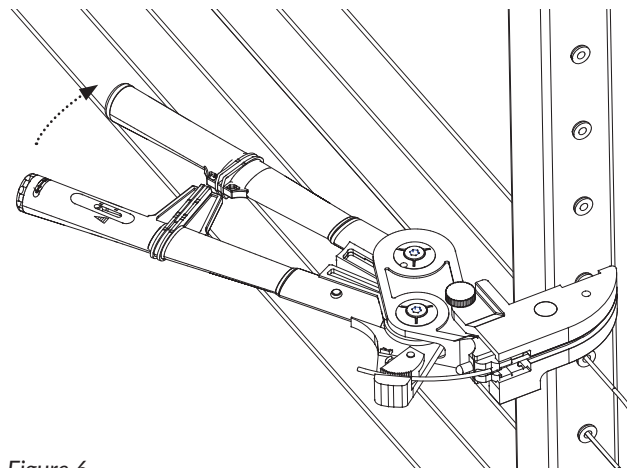

Figure 6